

SECTION A-A

ITEM NO.	PART NUMBER	DESCRIPTION	QTY.
10	MACH-004214	Body w Fill Port, CTS, HI35	1
20	MACH-004268	Cap, CTS, HI33-35	1
30	MACH-005527	Clevis, CTS, HI33-35	1
40	MACH-005604	Lever, CTS, HI33-35	1
50	HDW-005573	Knob, Connect, McMaster, 6046K4	1
60	MACH-004679	Stem w Fill Port, CTS, HI35	1
70	HDW-034019	Washer, Connect, Flat Reid, FW-5	1
80	HDW-005412	Spring, Connect, LC-063L-2-S	1
90	HDWX-035090	Screw, Socket Set, .25-20 x .3125in	1
100	HDWX-035093	Dowel Pin, Connect, .25 x 1.125in	1
110	SEAX-008541	ORING, 115, Buna-N	2
120	MACH-005571	Handle, CTS, HI30-35	1
130	HDW-005566	Handle Grip, Connect, SA-1073	1
140	SEAL-005345	Seal, CTS, HI35-AB1	1
150	MACH-004403	Nose, CTS, HI35-AB1	1
160	MACH-004559	Washer, CTS, HI35-AB1	1
170	MACH-004591	Spacer, CTS, CI35	1

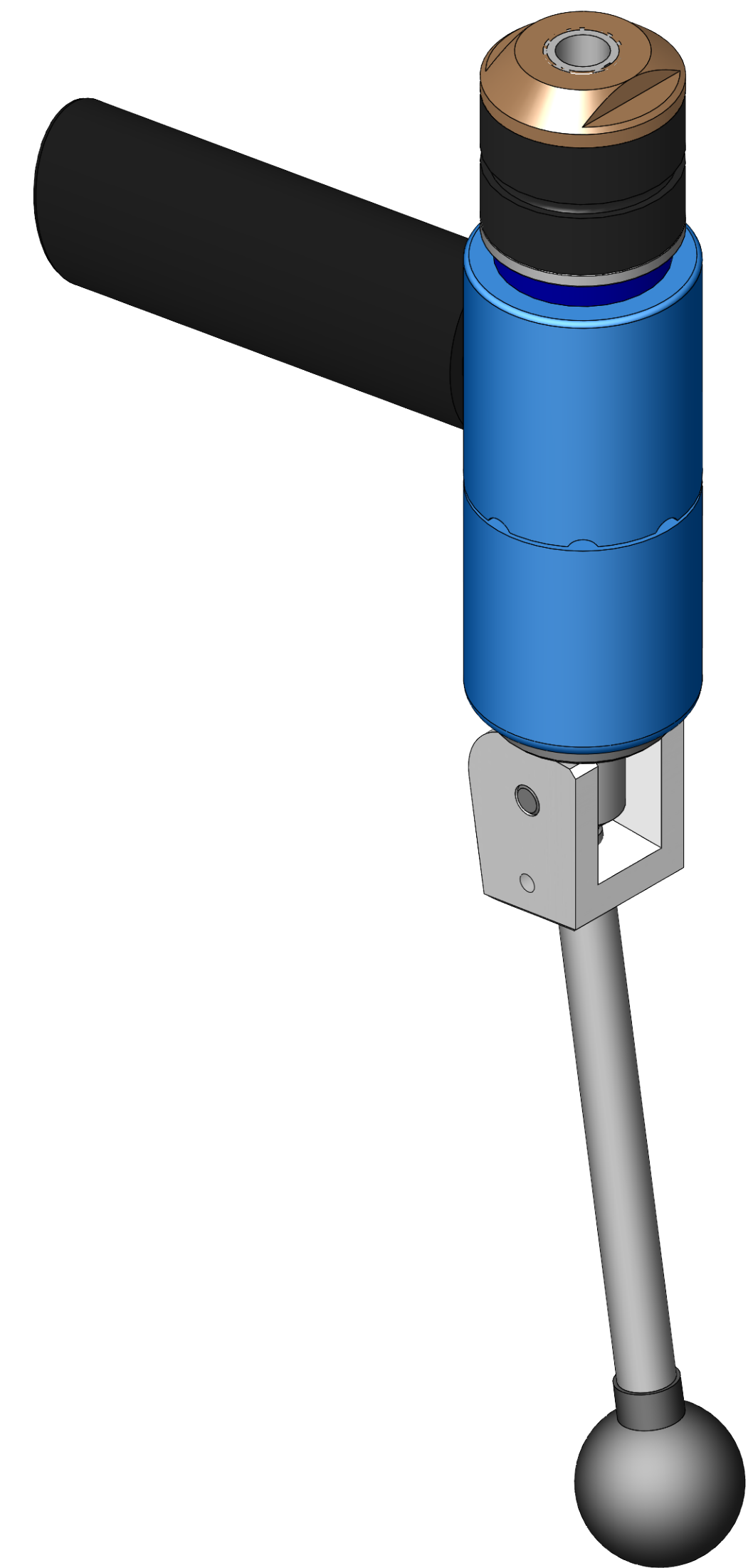

SIZE	DESCRIPTION		REV
D	Connect Assembly, CTS, HIH35-AB1		A
PART NUMBER		DATE	
CTSC-003585		10/19/18	
DRAWN BY		CHECKED BY	SHEET
		JAW	1 OF 1

FILE LOCATION: C:\Solidworks\PDM\PDW\R&D\Product Development\CTS Connects\HI\Connect Assembly\HIH\HIH35\CTSC-003585

Tuesday, July 1, 2025